



LUOYANG BLG BEARING INC.

1907, Tower B, Multinational Ginza.
12 Anhui RD, 471003 Luoyang China
Tel: 86-379-6468 7568
Fax: 86-379-6468 7169
E-mail: info@blgbearing.sina.net

Three-row roller slewing bearings

Three-row roller slewing bearings have three races, and their up and down and radial rollway nests are separated cause the loads of every rollers can be accurately defined. The up and down rollers could be the same diameter or not according to the feature of loads. Rollers with smaller diameter are usually adopted due to erected one-row rollers carrying radial force which have margin loading capacity. Three-row roller slewing bearings can accommodate every load and have good loading capacity. According to whether with gears, Three-row roller slewing bearings can be divided into without gear type (Fig 1), internal gear type (Fig 2) and external gear type (Fig 3). They are especially suitable for heavy-duty machines which require large working radius, such as bucket-wheel excavators, wheeled cranes, ship cranes, ladle turret, heavy duty mobile cranes, etc.

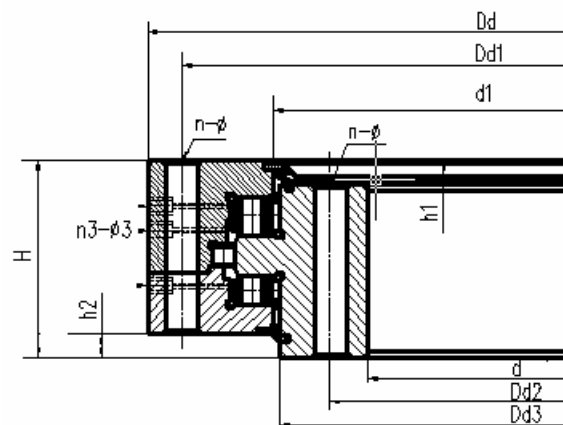

Fig 1 Three-row roller slewing bearings without gear

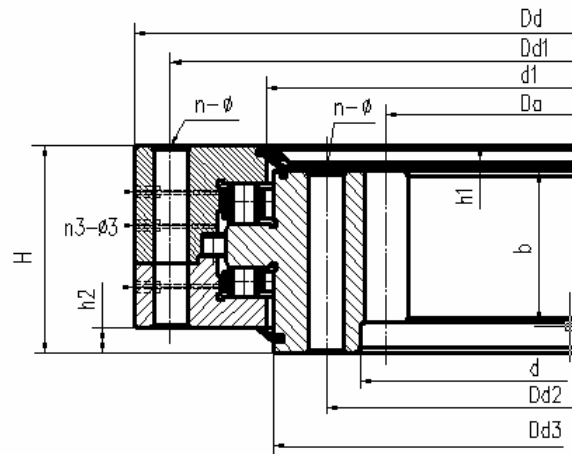

Fig 2 Three-row roller slewing bearings with internal gear

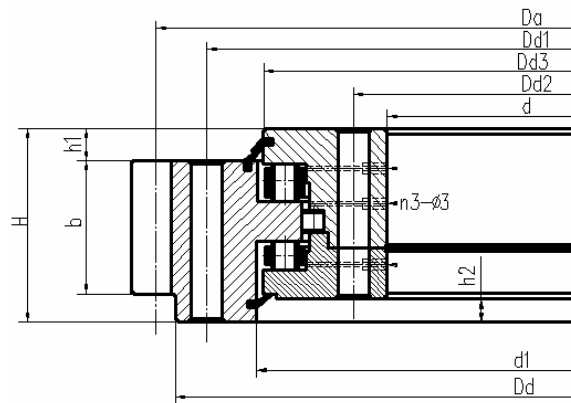

Fig 3 Three-row roller slewing bearings with external gear

Dimensions	Dd	d	H	Dd1	Dd2	n	φ	Dd3	d1	h1	h2	n3	φ3	m	Da
130. 32. 900	1064	736	182	1020	780	36	22	941	930	40	10	4.2	M10×1		
131. 32. 900	1064	736	182	1020	780	36	22	941	930	40	10	4.2	M10×1	8	1102.4
132. 32. 900	1064	736	182	1020	780	36	22	870	859	40	10	4.2	M10×1	10	1108
133. 32. 900	1064	736	182	1020	780	36	22	941	930	40	10	4.2	M10×1	8	691.2
134. 32. 900	1064	736	182	1020	780	36	22	870	859	40	10	4.2	M10×1	10	694
130. 32. 1000	1164	836	182	1120	880	40	22	1041	1030	40	10	5.2	M10×1		
131. 32. 1000	1164	836	182	1120	880	40	22	1041	1030	40	10	5.2	M10×1	10	1218
132. 32. 1000	1164	836	182	1120	880	40	22	970	959	40	10	5.2	M10×1	12	1221.6
133. 32. 1000	1164	836	182	1120	880	40	22	1041	1030	40	10	5.2	M10×1	10	784
134. 32. 1000	1164	836	182	1120	880	40	22	970	959	40	10	5.2	M10×1	12	784.8
130. 32. 1120	1284	956	182	1240	1000	40	22	1161	1150	40	10	5.2	M10×1		
131. 32. 1120	1284	956	182	1240	1000	40	22	1161	1150	40	10	5.2	M10×1	10	1338
132. 32. 1120	1284	956	182	1240	1000	40	22	1090	1079	40	10	5.2	M10×1	12	1341.6

Dimensions	Dd	d	H	Dd1	Dd2	n	ϕ	Dd3	d1	h1	h2	n3	$\phi 3$	m	Da
133.32.1120	1284	956	182	1240	1000	40	22	1161	1150	40	10	5.2	M10×1	10	904
134.32.1120	1284	956	182	1240	1000	40	22	1090	1079	40	10	5.2	M10×1	12	904.8
130.40.1250	1445	1055	220	1393	1107	45	26	1300	1290	50	10	5.2	M10×1		
131.40.1250	1445	1055	220	1393	1107	45	26	1300	1290	50	10	5.2	M10×1	12	1509.6
132.40.1250	1445	1055	220	1393	1107	45	26	1210	1200	50	10	5.2	M10×1	14	1509.2
133.40.1250	1445	1055	220	1393	1107	45	26	1300	1290	50	10	5.2	M10×1	12	988.8
134.40.1250	1445	1055	220	1393	1107	45	26	1210	1200	50	10	5.2	M10×1	14	985.6
130.40.1400	1595	1205	220	1543	1257	45	26	1450	1440	50	10	5.2	M10×1		
131.40.1400	1595	1205	220	1543	1257	45	26	1450	1440	50	10	5.2	M10×1	12	1665.6
132.40.1400	1595	1205	220	1543	1257	45	26	1360	1350	50	10	5.2	M10×1	14	1663.2
133.40.1400	1595	1205	220	1543	1257	45	26	1450	1440	50	10	5.2	M10×1	12	1144.8
134.40.1400	1595	1205	220	1543	1257	45	26	1360	1350	50	10	5.2	M10×1	14	1139.6
130.40.1600	1795	1405	220	1743	1457	48	26	1650	1640	50	10	6.2	M10×1		
131.40.1600	1795	1405	220	1743	1457	48	26	1650	1640	50	10	6.2	M10×1	14	1873.2
132.40.1600	1795	1405	220	1743	1457	48	26	1560	1550	50	10	6.2	M10×1	16	1868.8
133.40.1600	1795	1405	220	1743	1457	48	26	1650	1640	50	10	6.2	M10×1	14	1335.6
134.40.1600	1795	1405	220	1743	1457	48	26	1560	1550	50	10	6.2	M10×1	16	1334.4
130.40.1800	1995	1605	220	1943	1657	48	26	1850	1840	50	10	6.2	M10×1		
131.40.1800	1995	1605	220	1943	1657	48	26	1850	1840	50	10	6.2	M10×1	14	2069.2
132.40.1800	1995	1605	220	1943	1657	48	26	1760	1750	50	10	6.2	M10×1	16	2076.8
133.40.1800	1995	1605	220	1943	1657	48	26	1850	1840	50	10	6.2	M10×1	14	1531.6
134.40.1800	1995	1605	220	1943	1657	48	26	1760	1750	50	10	6.2	M10×1	16	1526.4
130.45.2000	2221	1779	231	2155	1845	60	33	2055	2033	54	12	6.2	M10×1		
131.45.2000	2221	1779	231	2155	1845	60	33	2055	2033	54	12	6.2	M10×1	16	2300.8
132.45.2000	2221	1779	231	2155	1845	60	33	1967	1945	54	12	6.2	M10×1	18	2300.4
133.45.2000	2221	1779	231	2155	1845	60	33	2055	2033	54	12	6.2	M10×1	16	1702.4
134.45.2000	2221	1779	231	2155	1845	60	33	1967	1945	54	12	6.2	M10×1	18	1699.2
130.45.2240	2461	2019	231	2395	2085	60	33	2295	2273	54	12	6.2	M10×1		
131.45.2240	2461	2019	231	2395	2085	60	33	2295	2273	54	12	6.2	M10×1	16	2556.8
132.45.2240	2461	2019	231	2395	2085	60	33	2207	2185	54	12	6.2	M10×1	18	2552.4
133.45.2240	2461	2019	231	2395	2085	60	33	2295	2273	54	12	6.2	M10×1	16	1926.4
134.45.2240	2461	2019	231	2395	2085	60	33	2207	2185	54	12	6.2	M10×1	18	1933.2
130.45.2500	2721	2279	231	2655	2345	72	33	2555	2561	54	12	8.2	M10×1		
131.45.2500	2721	2279	231	2655	2345	72	33	2555	2561	54	12	8.2	M10×1	18	2822.4
132.45.2500	2721	2279	231	2655	2345	72	33	2467	2445	54	12	8.2	M10×1	20	2816
133.45.2500	2721	2279	231	2655	2345	72	33	2555	2561	54	12	8.2	M10×1	18	2185.2
134.45.2500	2721	2279	231	2655	2345	72	33	2467	2445	54	12	8.2	M10×1	20	2188
130.45.2800	3021	2579	231	2955	2645	72	33	2855	2833	54	12	8.2	M10×1		
131.45.2800	3021	2579	231	2955	2645	72	33	2855	2833	54	12	8.2	M10×1	18	3110.4

Dimensions	Dd	d	H	Dd1	Dd2	n	φ	Dd3	d1	h1	h2	n3	φ3	m	Da
132. 45. 2800	3021	2579	231	2955	2645	72	33	2767	2745	54	12	8. 2	M10×1	20	3116
133. 45. 2800	3021	2579	231	2955	2645	72	33	2855	2833	54	12	8. 2	M10×1	18	2491. 2
134. 45. 2800	3021	2579	231	2955	2645	72	33	2767	2745	54	12	8. 2	M10×1	20	2488
130. 50. 3150	3432	2868	270	3342	2958	72	45	3213	3196	65	12	8. 2	M10×1		
131. 50. 3150	3432	2868	270	3342	2958	72	45	3213	3196	65	12	8. 2	M10×1	20	3536
132. 50. 3150	3432	2868	270	3342	2958	72	45	3104	3087	65	12	8. 2	M10×1	22	3537. 6
133. 50. 3150	3432	2868	270	3342	2958	72	45	3213	3196	65	12	8. 2	M10×1	20	2768
134. 50. 3150	3432	2868	270	3342	2958	72	45	3104	3087	65	12	8. 2	M10×1	22	2758. 8
130. 50. 3550	3832	3268	270	3742	3358	72	45	3613	3596	65	12	8. 2	M10×1		
131. 50. 3550	3832	3268	270	3742	3358	72	45	3613	3596	65	12	8. 2	M10×1	20	3936
132. 50. 3550	3832	3268	270	3742	3358	72	45	3504	3487	65	12	8. 2	M10×1	22	3933. 6
133. 50. 3550	3832	3268	270	3742	3358	72	45	3613	3596	65	12	8. 2	M10×1	20	3168
134. 50. 3550	3832	3268	270	3742	3358	72	45	3504	3487	65	12	8. 2	M10×1	22	3154. 8
130. 50. 4000	4282	3718	270	4192	3908	80	45	4063	4046	65	12	8. 2	M10×1		
131. 50. 4000	4282	3718	270	4192	3908	80	45	4063	4046	65	12	8. 2	M10×1	22	4395. 6
132. 50. 4000	4282	3718	270	4192	3908	80	45	3954	3937	65	12	8. 2	M10×1	25	4395
133. 50. 4000	4282	3718	270	4192	3908	80	45	4063	4046	65	12	8. 2	M10×1	22	3616. 8
134. 50. 4000	4282	3718	270	4192	3908	80	45	3954	3937	65	12	8. 2	M10×1	25	3610
130. 50. 4500	4782	4218	270	4692	4308	80	45	4563	4546	65	12	8. 2	M10×1		
131. 50. 4500	4782	4218	270	4692	4308	80	45	4563	4546	65	12	8. 2	M10×1	22	4901. 6
132. 50. 4500	4782	4218	270	4692	4308	80	45	4454	4437	65	12	8. 2	M10×1	25	4895
133. 50. 4500	4782	4218	270	4692	4308	80	45	4563	4546	65	12	8. 2	M10×1	22	4122. 8
134. 50. 4500	4782	4218	270	4692	4308	80	45	4454	4437	65	12	8. 2	M10×1	25	4110